



# ICD BROOKFIELD PLACE

— DUBAI —

**FLOOR PLANS**

# SCHEDULE

# OF AREAS

**NIA TOTAL: 1,157,573 SQ FT**  
**TOTAL OFFICE: 991,324 SQ FT**  
**TOTAL RETAIL: 166,249 SQ FT**  
**CAR PARKS: 2,700**  
**TOTAL LIFTS: 46**

|                                 | L         | SQ FT  |
|---------------------------------|-----------|--------|
| <b>SKY SUITES (L51 - 53)</b>    |           |        |
|                                 | <b>53</b> | 8,903  |
| 2 LIFTS                         |           |        |
|                                 | <b>52</b> | 8,389  |
|                                 | <b>51</b> | 17,796 |
| <b>HIGH-RISE (L39 - 50)</b>     | <b>50</b> | 17,704 |
|                                 | <b>49</b> | 17,944 |
| 6 LIFTS                         | <b>48</b> | 18,174 |
|                                 | <b>47</b> | 18,396 |
|                                 | <b>46</b> | 18,293 |
|                                 | <b>45</b> | 18,496 |
|                                 | <b>44</b> | 18,691 |
|                                 | <b>43</b> | 18,876 |
|                                 | <b>42</b> | 17,825 |
|                                 | <b>41</b> | 18,827 |
|                                 | <b>40</b> | 18,985 |
| <b>HIGH MID-RISE (L28 - 38)</b> | <b>39</b> | 19,145 |
|                                 | <b>38</b> | 19,183 |
| 6 LIFTS                         | <b>37</b> | 19,334 |
|                                 | <b>36</b> | 19,442 |
|                                 | <b>35</b> | 19,536 |
|                                 | <b>34</b> | 19,618 |
|                                 | <b>33</b> | 19,687 |
|                                 | <b>32</b> | 19,742 |
|                                 | <b>31</b> | 19,784 |
|                                 | <b>30</b> | 17,885 |
|                                 | <b>29</b> | 17,744 |
|                                 | <b>28</b> | 18,929 |
| <b>LOW MID-RISE (L17 - 27)</b>  | <b>27</b> | 18,890 |
|                                 | <b>26</b> | 18,877 |
| 6 LIFTS                         | <b>25</b> | 18,519 |
|                                 | <b>24</b> | 18,471 |
|                                 | <b>23</b> | 18,409 |
|                                 | <b>22</b> | 18,333 |
|                                 | <b>21</b> | 16,993 |
|                                 | <b>20</b> | 18,478 |
|                                 | <b>19</b> | 18,364 |
|                                 | <b>18</b> | 17,497 |
|                                 | <b>17</b> | 18,114 |
| <b>LOW-RISE (L6 - 16)</b>       | <b>16</b> | 18,679 |
|                                 | <b>15</b> | 19,264 |
| 6 LIFTS                         | <b>14</b> | 19,778 |
|                                 | <b>13</b> | 20,251 |
|                                 | <b>12</b> | 20,683 |
|                                 | <b>11</b> | 21,076 |
|                                 | <b>10</b> | 21,427 |
|                                 | <b>9</b>  | 21,738 |
|                                 | <b>8</b>  | 22,009 |
|                                 | <b>7</b>  | 21,779 |
|                                 | <b>6</b>  | 21,889 |
| <b>PODIUM (LG - 5)</b>          |           |        |
| 3 LIFTS                         | <b>5</b>  | PLANT  |
| 2 LIFTS                         | <b>4</b>  | 30,949 |
|                                 | <b>3</b>  | 30,724 |
|                                 | <b>2</b>  | 30,359 |
|                                 | <b>1</b>  |        |
| 6 CAR PARK LIFTS                | <b>G</b>  | 2,447  |
| 2 TOWER + 7 PODIUM GOODS LIFTS  |           |        |
| 1 TOWER + 1 PODIUM FIRE LIFTS   |           |        |

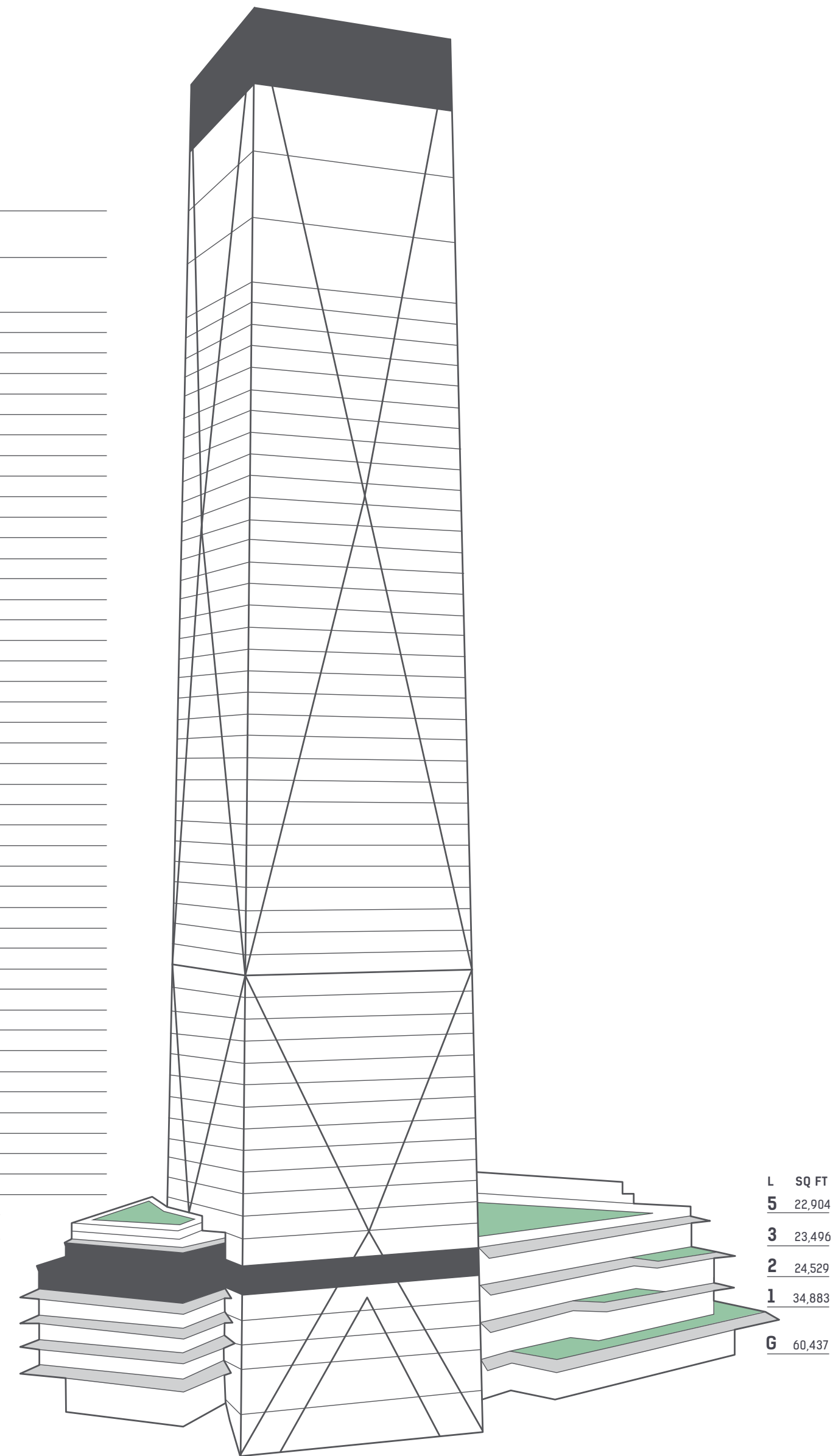

LEVEL

GROUND

RECEPTION: 11,367 SQ FT

MEMBERS CLUB: 1,982 SQ FT

LEASABLE AREAS:

G02: 6,775 SQ FT

G03: 1,847 SQ FT

G04: 3,467 SQ FT

G05: 2,058 SQ FT

G06: 1,217 SQ FT

G07: 1,037 SQ FT

G08: 11,777 SQ FT

G09: 425 SQ FT

G10: 849 SQ FT

G11: 1,315 SQ FT

G12: 2,242 SQ FT

G13: 4,142 SQ FT

G14: 1,430 SQ FT

G15: 19,367 SQ FT

AMSL: 3M

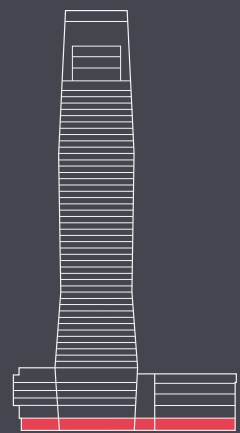

# LEVEL

## ONE

RECEPTION: 5,942 SQ FT

SUMMER GARDEN: 21,650 SQ FT

MEMBERS CLUB: 12,201 SQ FT

### LEASABLE AREAS:

L01:02: 696 SQ FT

L01:03: 2,376 SQ FT

L01:04: 723 SQ FT

L01:05: 4,849 SQ FT + 2,822 SQ FT (TERRACE)

L01:06: 2,182 SQ FT

L01:07: 3,163 SQ FT

L01:08: 2,034 SQ FT

AMSL: 11M

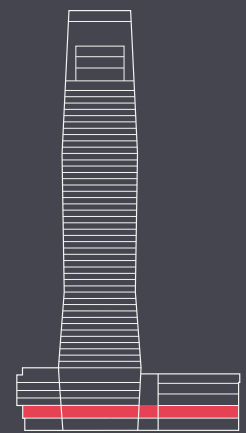

LOW-

RISE

LEVELS: 6-16

OFFICE: 19,264 SQ FT

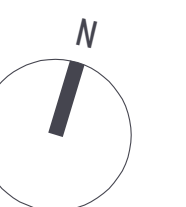
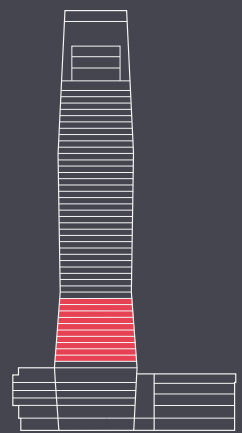
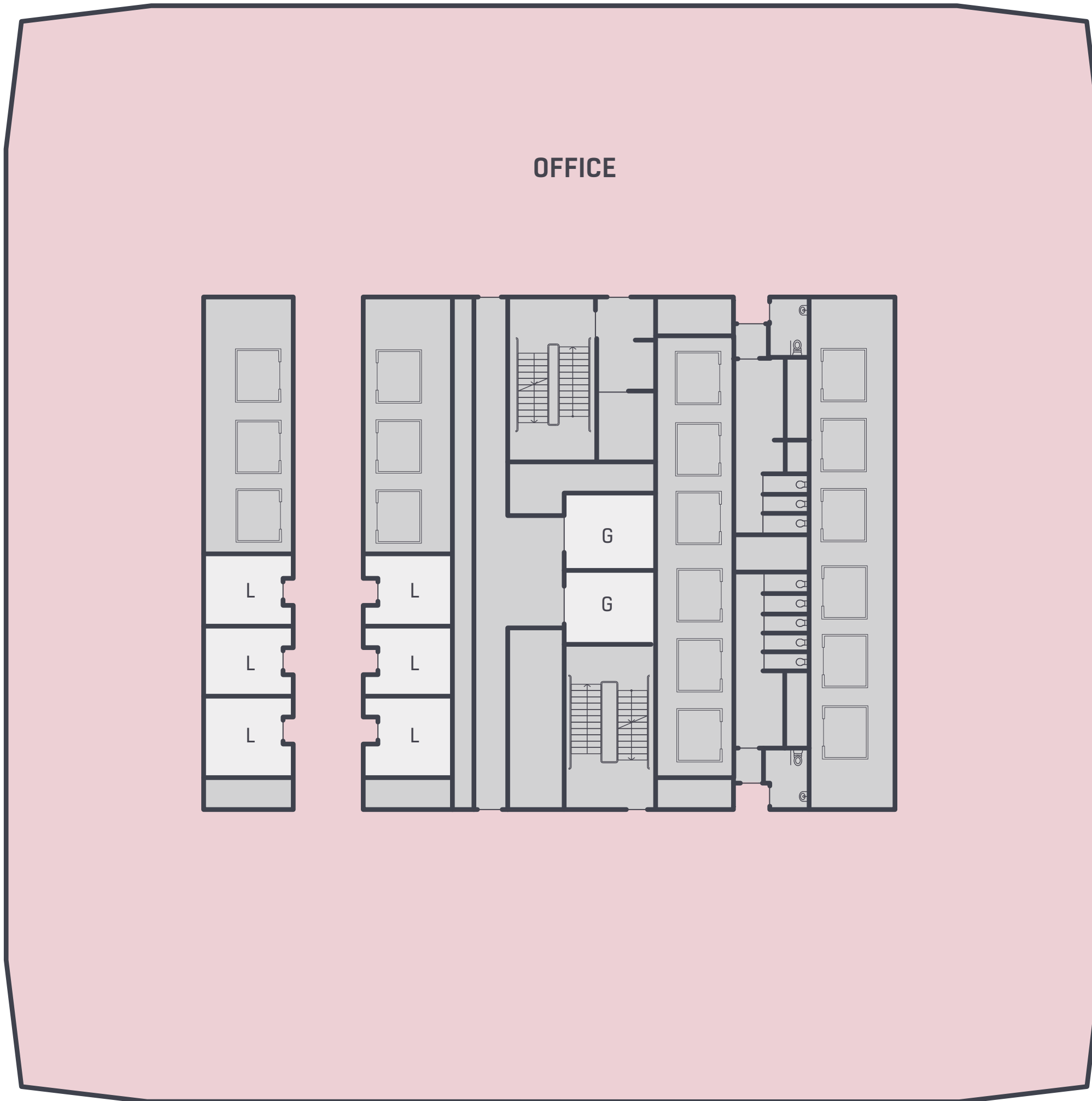

LOW

MID-RISE

LEVELS: 7-27

OFFICE: 18,877 SQ FT

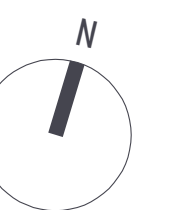
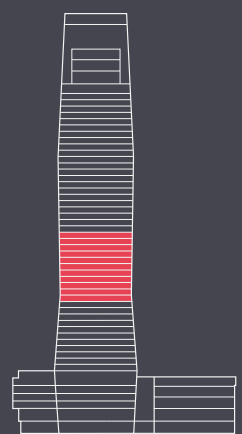
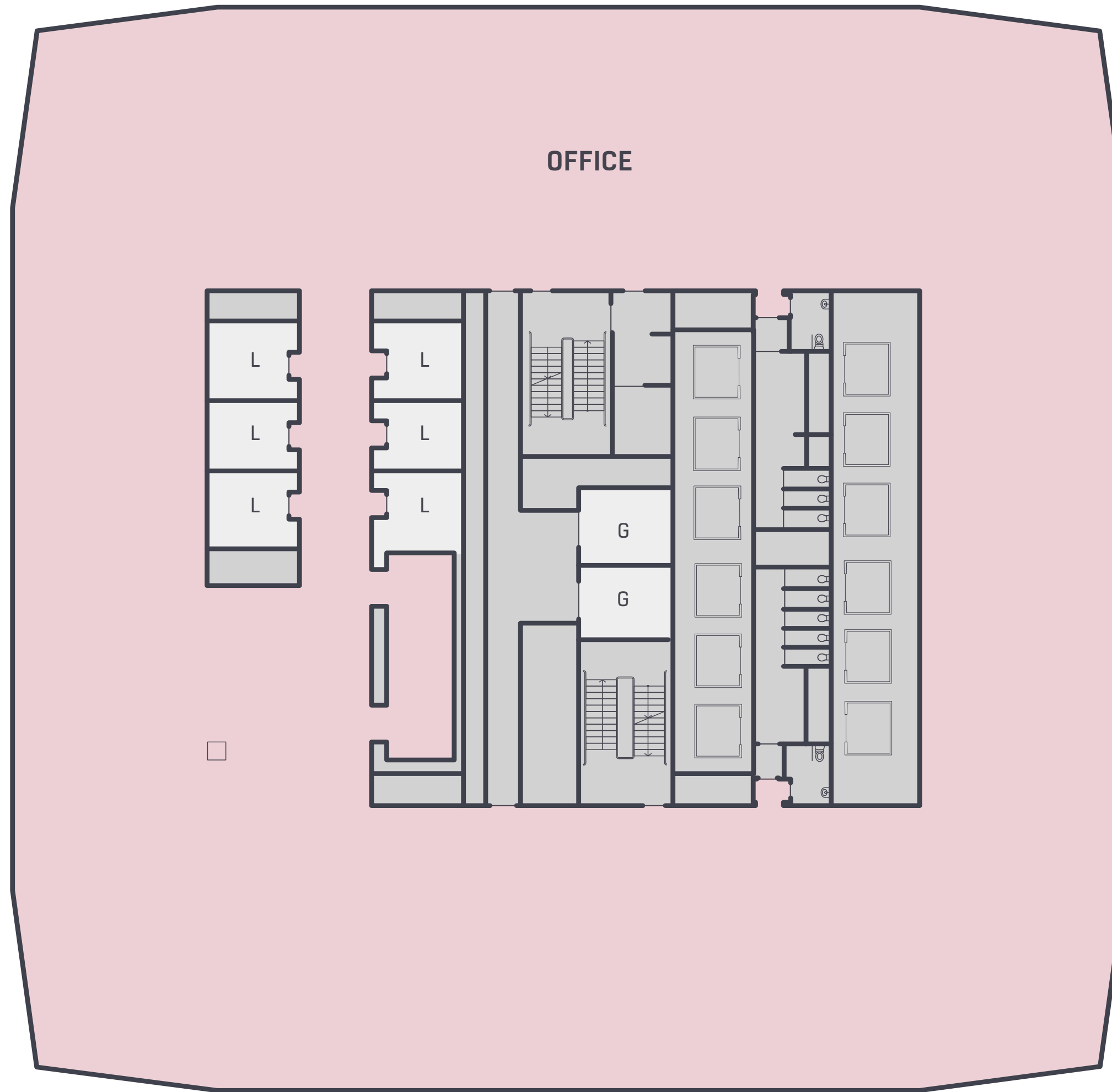

HIGH

MID-RISE

LEVELS: 28-38

OFFICE: 19,334 SQ FT

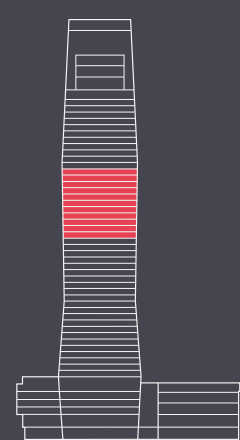
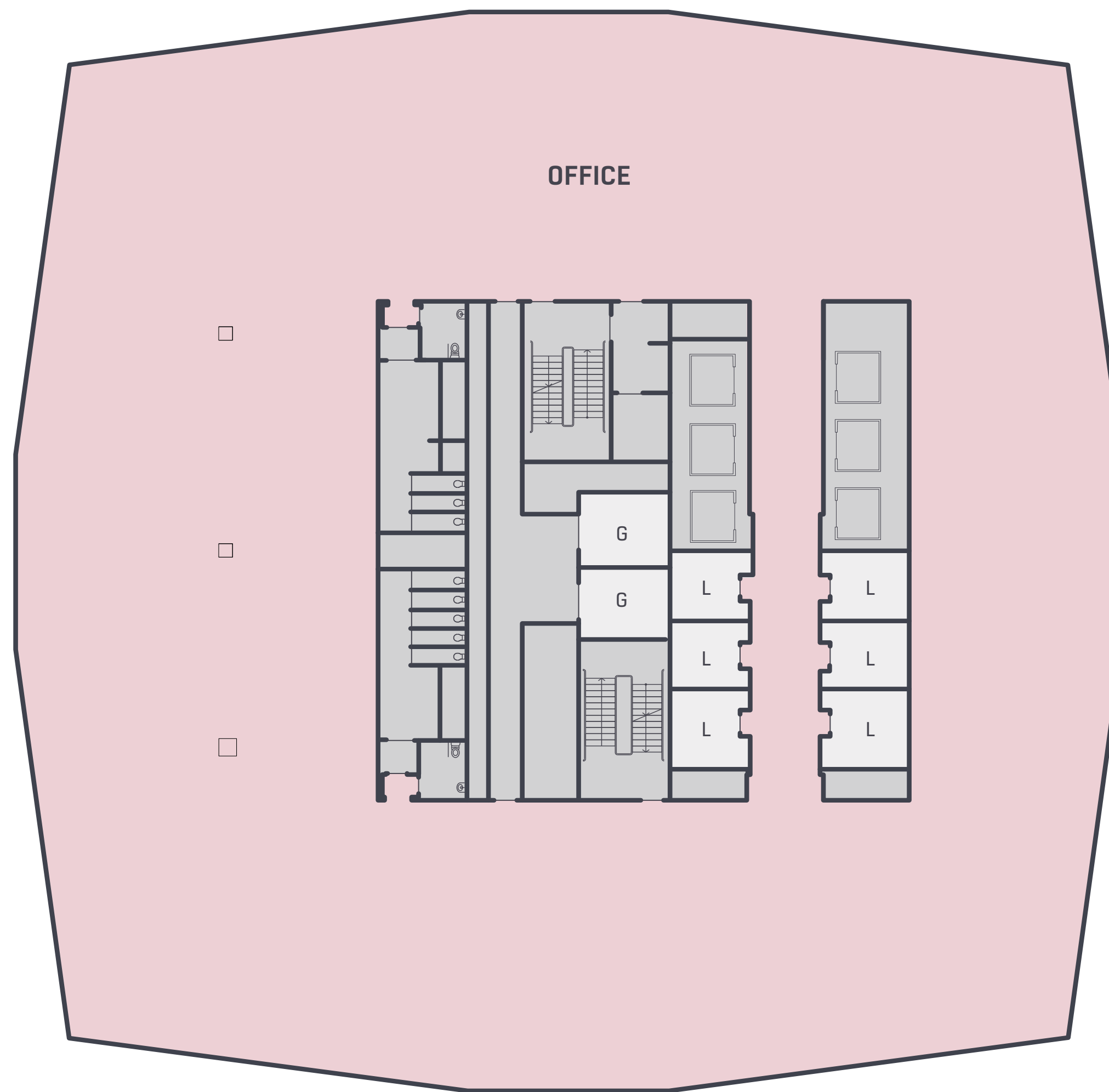

MAKKAH

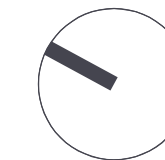

N

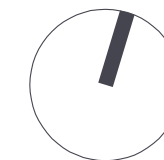

HIGH-

RISE

LEVELS: 39-50

OFFICE: 17,944 SQ FT

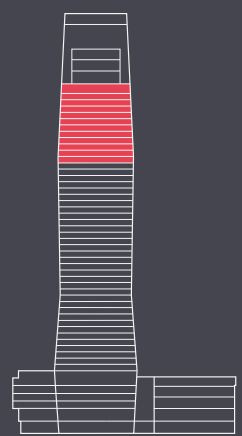
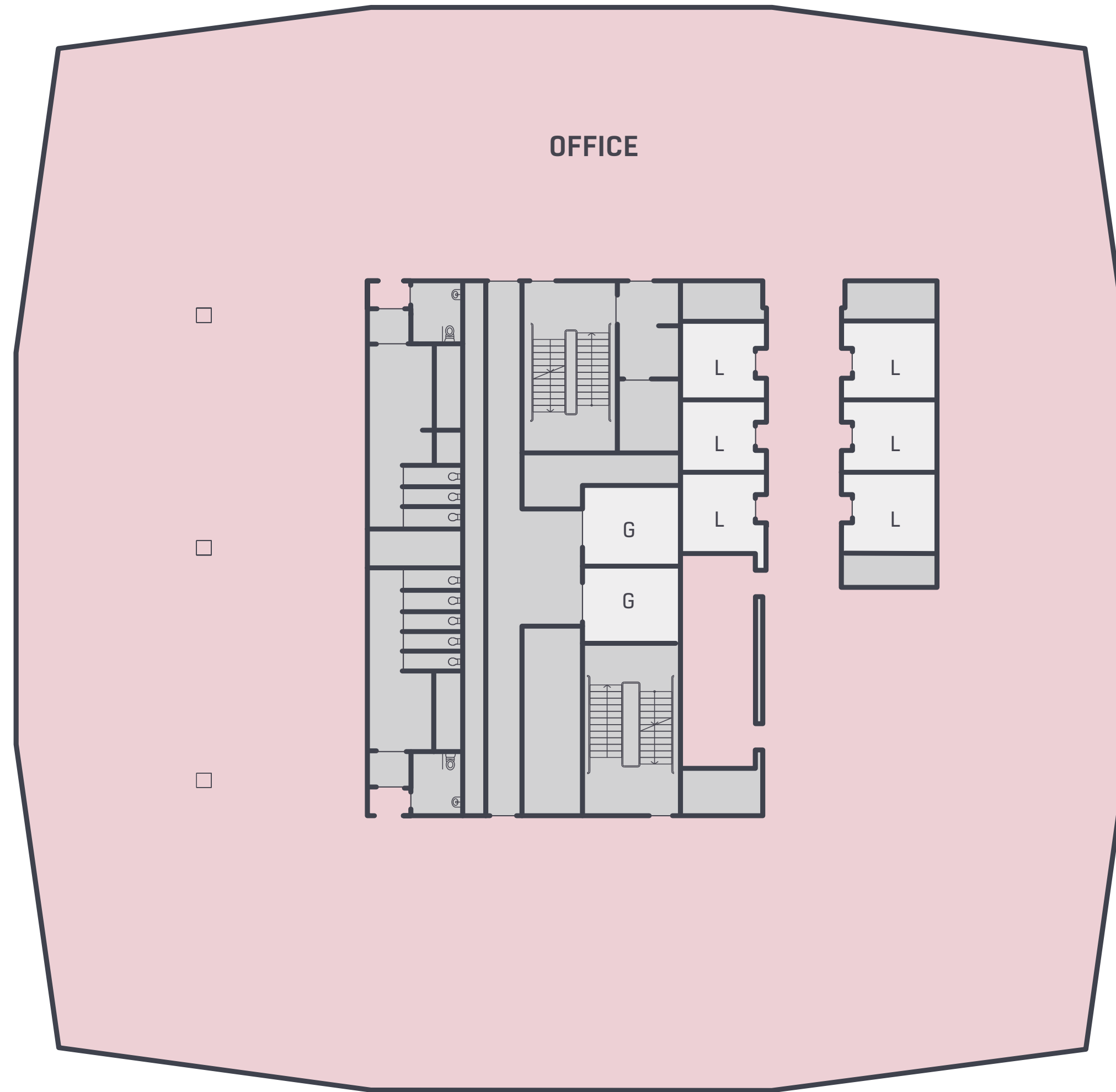

MAKKAH

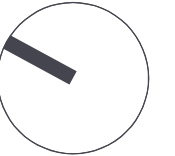

N

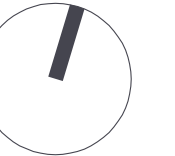



SKY

SUITES

LEVELS: 51-53

OFFICE: 17,796 SQ FT

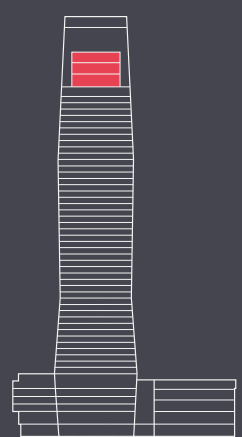
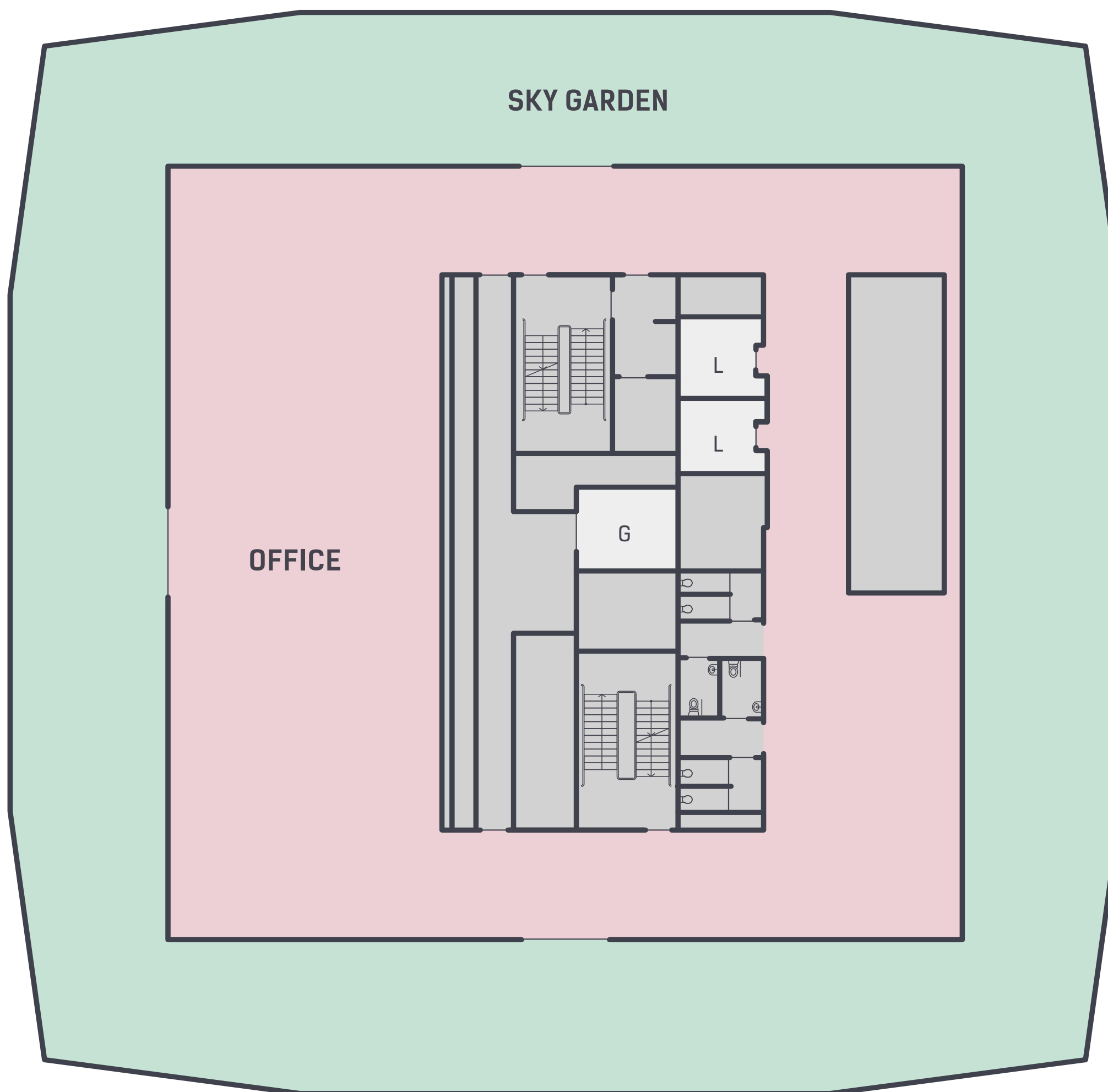

MAKKAH

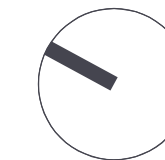

N

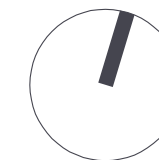

**RISER ACCESS**

Tenant riser access within the core increases space planning options and usage of floor space around the core.

**DUAL ACCESS FROM SERVICE CORRIDOR**

Dual access to both service corridor and goods lifts enhances subdivisibility of the floorplates.

**PROVISION FOR ESCAPE**

Evacuation and firefighting.

**SEPARATE GOODS LIFT LOBBY**

Enhanced security & passenger lift performance

**DESTINATION CONTROL LIFTING**

Lifts on destination controls provide direct access throughout the building from the main lobby, resulting in reduced waiting and travel times.

